

~~Cabinet
Discounters~~

Kitchen Planning Guide

Your First Step
Toward Making Your
Kitchen Dreams Come True!

www.CabinetDiscounters.com

Kitchen Planning Guide

Start by Measuring Your Kitchen Space: Your distributor is an expert in kitchen design. He'll customize a new kitchen for you, building in beauty, convenience and a wealth of storage space. Just show him a diagram of the kitchen.

The Diagram is Easy. All you need is a tape measure, a pencil and the simple layout grid on the back of this booklet. Just be sure you get all the measurements written down. The rough drawing you do of your kitchen space will look like this.

Start Here. Measure the sink window wall first. Start in the corner. Measure (in inches) to the edge of the window trim.

Windows and Doors. Mark in width from outside of trim to outside of trim. Fill in full dimensional data at bottom of this page.

Continue... Working clockwise, record all measurements of the room, noting any "breaks" like doors, offsets, etc.

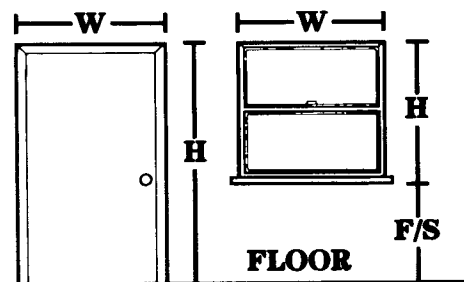
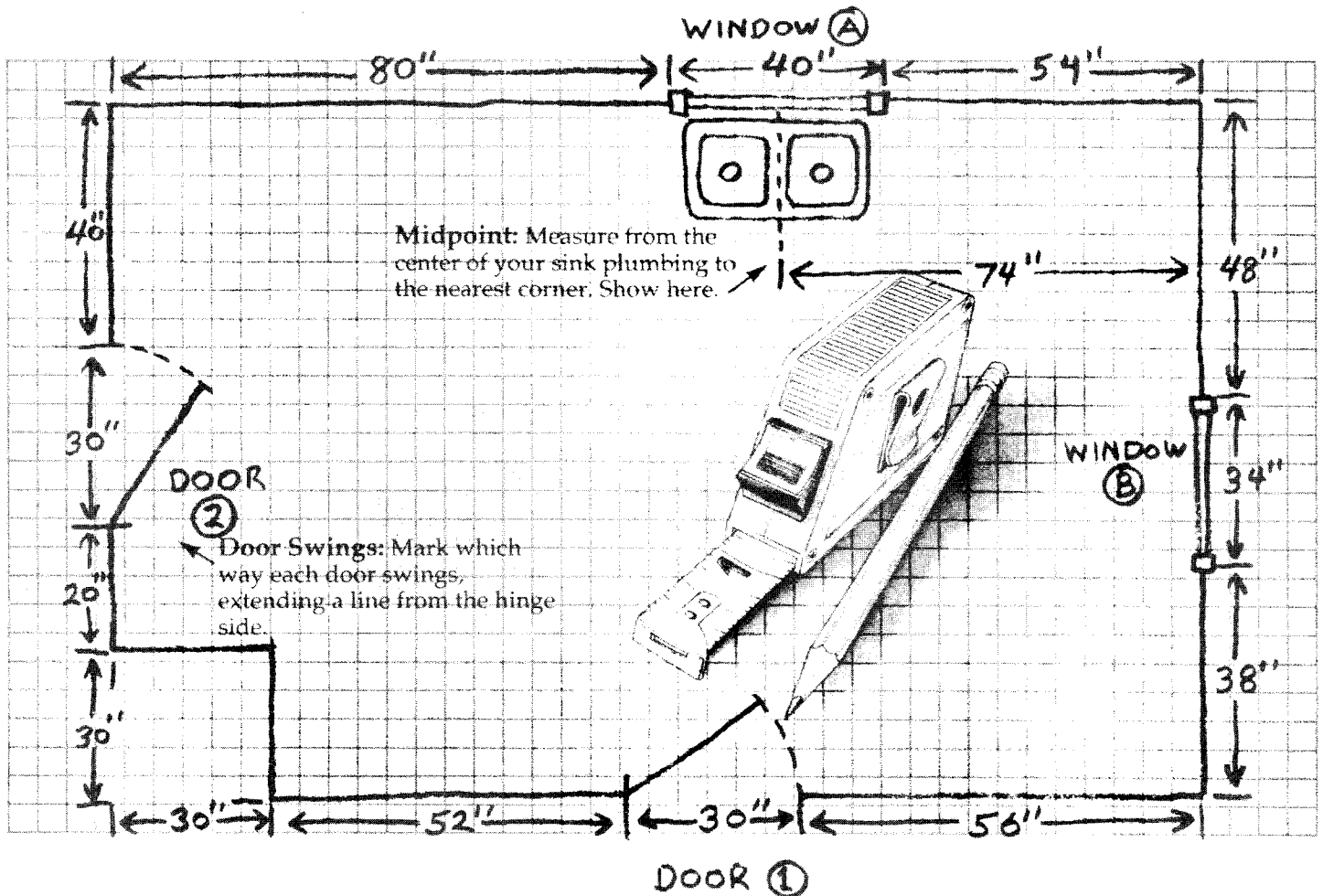

Window	A	B	C	D
HT (Height)	"	"	"	"
F/S (Floor/Sill)	"	"	"	"
HT+F/S TOTAL	"	"	"	"

Door height(s): _____"

Ceiling height: _____"

Windows and Doors: Show width of each door and window on above drawing. Label Window A, Window B; Door 1, Door 2, etc.

Planning Details

1. This plan is for Remodeling New Home
2. If you are remodeling, are you adding New subfloor Drywall or Paneling over present wall.
3. The age of your house is _____ years.
4. Interior kitchen walls are Drywall Plaster Block Brick.
5. Exterior walls are Wood Permanent siding Brick Block Stucco.
6. Kitchen floor construction (underneath vinyl flooring, carpet or tile) is Wood Concrete.
7. If you have soffits: the height from floor to soffit is _____; soffit depth is _____.
8. Kitchen table normally seats _____ persons.
9. Dimensions of existing table are _____" wide by _____" long; or round _____" in diameter.

Options Planning

Which of these Options would you like to see included in your new kitchen if space permits.

- Appliance garage with handsome tambor doors
- Built-in wine rack to add real beauty
- Chef's pantry with huge storage capacity
- Tall utility cabinet with roll-out drawers
- Range hood housed in matching wood cabinet
- Microwave cabinet for eye level convenience
- Decorative book case to display your treasures
- Corner cabinets with swing-out shelves
- Lazy susan units in wall or base cabinets
- Tray cabinet to provide divided storage space
- Roll-out shelves to add real convenience
- Spice rack to multiply utility space
- Built-in trash basket in a base cabinet
- Cutlery drawer, chopping block and bread box contained in a single handy base cabinet unit
- Stained glass doors to add real beauty
- Sink tilt-out drawer to utilize normally wasted space
- Sliding towel rack on the back of sink door
- Swing-out cook book rack underneath wall cabinet
- Whatnot shelves to add dimension and beauty

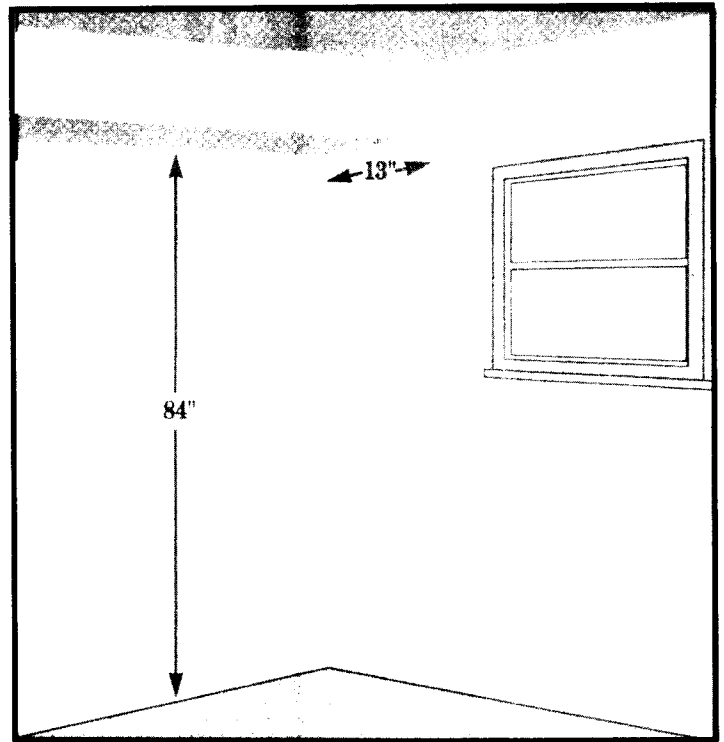

Soffits: A soffit is the bulkhead between the ceiling and the top of the cabinets. Distance from floor to soffit should be at least 84". (Allow 1/4" more if you install an 84" tall cabinet). Depth may vary. Normal is 13" - 1" deeper than a wall cabinet.

Many designers do not use soffits. In some cases, an extra-high 42" wall cabinet is used. In others, the space above the wall cabinets is left open.

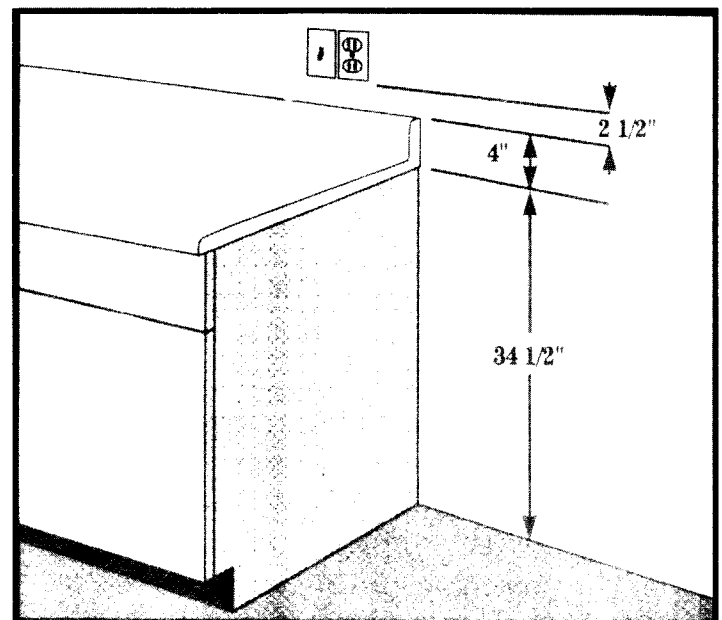

Base Clearance: You need 41" below windows and electrical wall outlets to fit in new base cabinets and a counter top with backsplash. This leaves 2 1/2" clearance above the counter top. If you have less than 1" clearance, consult your designer.

Scale: Each square equals _____ inches.

Wall 1

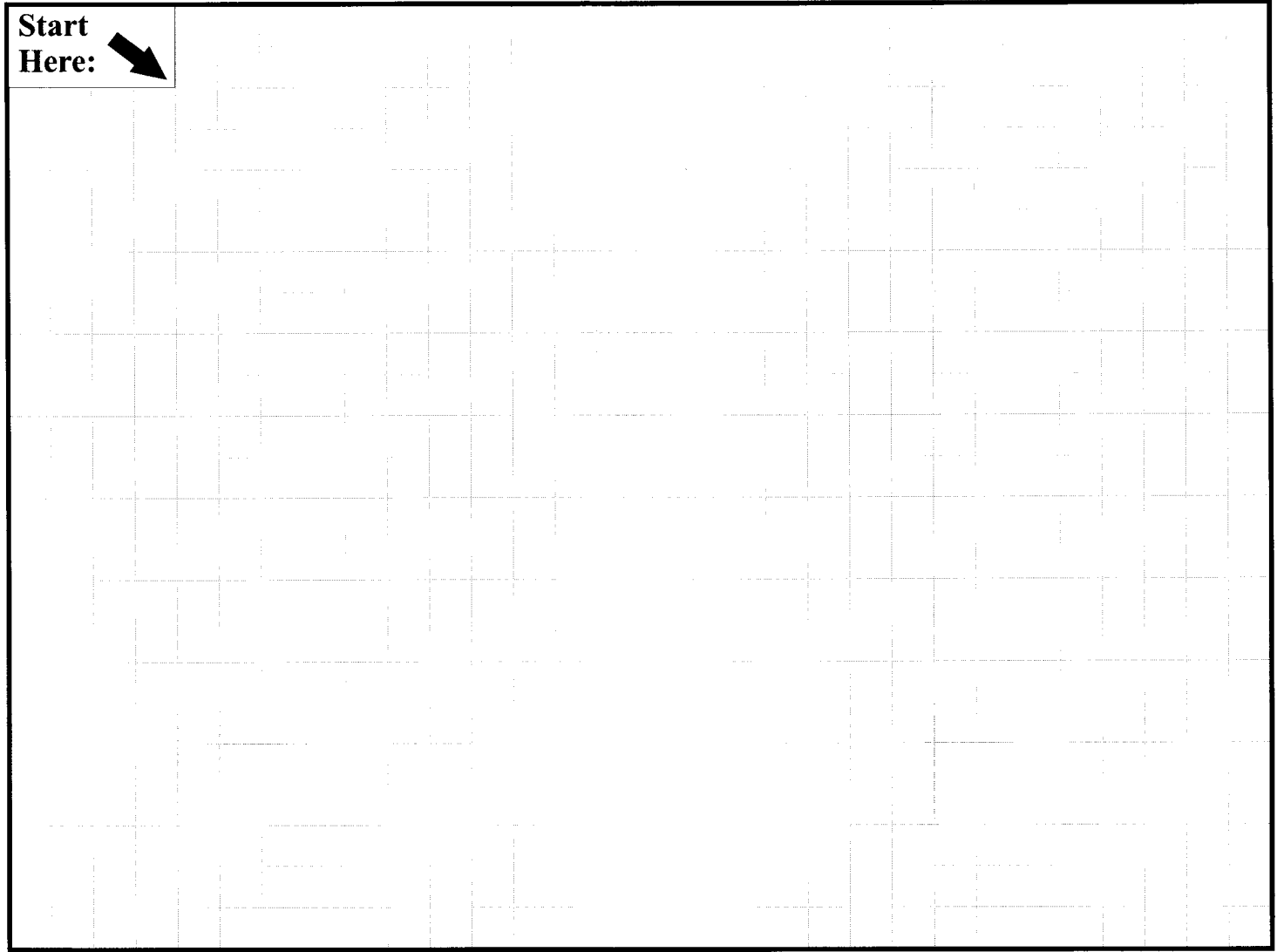

Wall 3

Dimension Totals:

Wall 1: _____ must total same as Wall 3: _____

Wall 2: _____ must total same as Wall 4: _____

Checklist:

1. Show all dimensions in inches.
2. Mark all breaks in walls (windows, doors, cold air returns, radiators, closets offsets, etc.).
3. Mark location of existing plumbing centerlines, electrical outlets, existing ducts to outside.
4. Indicate which are exterior walls.

NAME _____

ADDRESS _____

PHONE _____



ANNAPOLIS
 910-A Bestgate Rd.
 Annapolis, MD 21401
 410-266-9195/301-261-8883

MT. AIRY
 2704-B Back Acre Circle
 Mt. Airy, MD 21771
 301-829-7272

COLUMBIA
 9500 Berger Road
 Columbia, MD 21046
 410-381-5961/301-621-8062

CHANTILLY
 14501-F Lee-Jackson Hwy.
 Chantilly, VA 22021
 703-803-7990

GAITHERSBURG
 9153 Arbuckle Dr.
 Gaithersburg, MD 20877
 301-258-7360

SPRINGFIELD
 5228 Port Royal Rd.
 Springfield, VA 22151
 703-425-8822